



## FEATURES

- ◀ 4 person rectangular spa
- ◀ 10 therapeutic, variable-flow jets
- ◀ Patented Dura-Bond™ acrylic 3-layer shell strengthening system
- ◀ Soft-Touch™ Controls
- ◀ Energy Saver™ System
- ◀ WeatherGuard™ Maintenance Free Cabinet
- ◀ Includes lockable teak flex cover
- ◀ Available only in Blue Denim shell color

## SPECIFICATIONS

- ◀ **Dimensions:** 80 1/2" x 56 1/2" x 30" D
- ◀ **Gallons:** 240 (US)
- ◀ **Pumps:** (1) 2.2 HP Brake Torque (3.0 Continuous Duty) Pump (2-speed) With Energy Saver Ultra-Low Amp Draw
- ◀ **Heater:** 1.0 Kilowatts at 120 Volts
- ◀ **Lights:** 12 Volt (red/blue lens)
- ◀ **Voltage:** 1 Kilowatt heater at 120 Volt/ 4 Kilowatt heater at 240 Volt conversion (Requires an electrician)
- ◀ **Controls:** Balboa Digital Electronics with LCD temperature read-outs. The heat and humidity resistant microprocessor requires no programming.



## FEATURED JETS

*(some jets not pictured)*

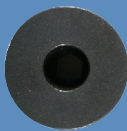

**POSI  
FLOW JET**

Creates the powerful massage that is most popular in spas.



**DIRECTIONAL  
HURRICANE SPA JET**

State of the art hydrotherapy performance. These jets feature total directional control and adjustable dial for various water flow levels.

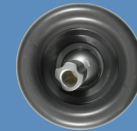

**VARI SWIRL  
HURRICANE SPA JET**

A single, large, adjustable nozzle jet. The jet rotates by using centrifugal force, providing increased water flow and massage.

## DURA-BOND™

This three-layer, patented, strengthening process combines the beauty of Lucite Plus Acrylic™ with a layer of ABS for shell strength and integrity. Then a double strengthening material is applied. This high density material has all the strengthening properties of fiberglass without the environmental concerns. The cabinet is insulated with a thick layer of polystyrene foam with radiant foil on the inside wall of foam and on the floor.

1. Acrylic Plus™
2. ABS
3. Dura-Bond™
4. WeatherGuard™ with Synthetic Reversible Panels
5. Polystyrene Insulation
6. Radiant Foil Insulation
7. Thermal Air Barrier
8. Moisture-Resistant Polyethylene Flooring

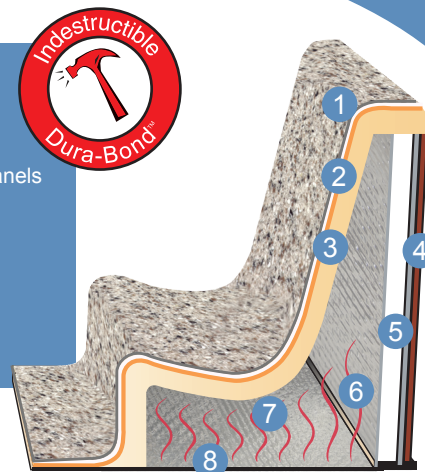

## ENERGY SAVER SYSTEM™

Heat is generated by the spa's power equipment inside the cabinet. This heated air is captured and returned to the spa's water. This continually helps maintain the water temperature without running the heater as often. The heat recovery system saves you money by reducing electrical cost.

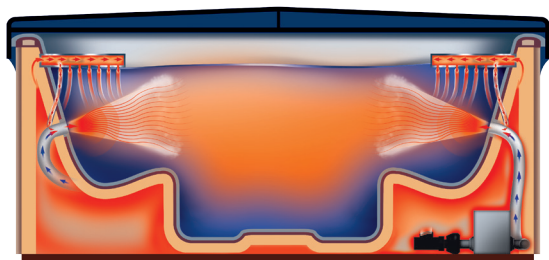

## SOFT-TOUCH™ CONTROLS

State-of-the-art digital electronic control with LCD temperature and filtration readout. All functions are conveniently located at your fingertips.



## MAINTENANCE FREE WEATHER GUARD™ CABINET

Our Synthetic cabinets are known for their rich, beautiful appearance and long lasting durability. Fully removable access panels make service a breeze.

