



## FEATURES

- ◀ 8 person rectangular non-lounger spa
- ◀ 4 contoured bucket seats, 3 bench seats, walk-in steps/cool down seat, and large footwell
- ◀ 40 therapeutic, variable-flow jets (includes 14-jet turbo massage)
- ◀ Patented Dura-Bond™ acrylic 3-layer shell strengthening system
- ◀ Built-in filter
- ◀ Soft-Touch™ Controls
- ◀ Energy Saver™ System
- ◀ Dura Frame™ Maintenance Free Cabinet
- ◀ Insulated, lockable, teak hard cover
- ◀ Your choice of Silver Marble or Blue Denim shell color

## SPECIFICATIONS

- ◀ **Dimensions:** 82" x 82" x 36" D
- ◀ **Gallons:** 475 (US)
- ◀ **Pumps:** (1) 4.0 HP Brake Torque (3.0 Continuous Duty) Pump (2-speed) With Energy Saver Ultra-Low Amp Draw
- ◀ **Heater:** 4.0 Kilowatts
- ◀ **Lights:** 12 Volt (red/blue lens)
- ◀ **Voltage:** 240-Volt System, requires 50 amp GFCI (*not included*)
- ◀ **Controls:** Balboa Digital Electronics with LCD temperature read-outs. The heat and humidity resistant microprocessor requires no programming.



## FEATURED JETS

(some jets not pictured)

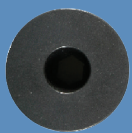

**POSI  
FLOW JET**

Creates the powerful massage that is most popular in spas.



**DIRECTIONAL  
HURRICANE SPA JET**

State of the art hydrotherapy performance. These jets feature total directional control and adjustable dial for various water flow levels.



**MASSAGE HURRICANE**

A 14-jet system that provides superior performance. Pamper yourself with a powerful, multi-level master massage.

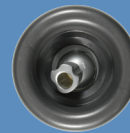

**VARI SWIRL  
HURRICANE SPA JET**

A single, large, adjustable nozzle jet. The jet rotates by using centrifugal force, providing increased water flow and massage.



**PLUS31™  
AIR INJECTOR**

Each recessed and mounted air injector consists of 31 outlets. These create a pulsating, "champagne" bubbling effect.

## DURA-BOND™

This three-layer, patented, strengthening process combines the beauty of Lucite Plus Acrylic™ with a layer of ABS for shell strength and integrity. Then a double strengthening material is applied. This high density material has all the strengthening properties of fiberglass without the environmental concerns. The cabinet is insulated with a thick layer of polystyrene foam with radiant foil on the inside wall of foam and on the floor.

1. Acrylic Plus™
2. ABS
3. Dura-Bond™
4. WeatherGuard™ with Synthetic Reversible Panels
5. Polystyrene Insulation
6. Radiant Foil Insulation
7. Thermal Air Barrier
8. Moisture-Resistant Polyethylene Flooring

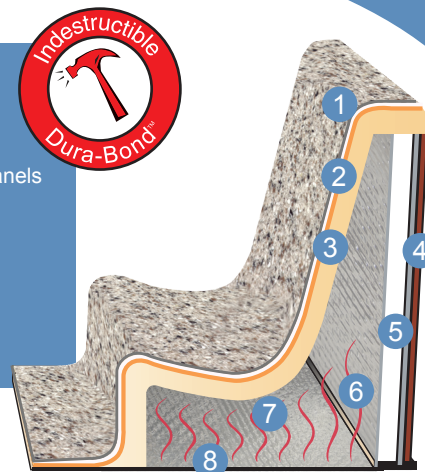

## ENERGY SAVER SYSTEM™

Heat is generated by the spa's power equipment inside the cabinet. This heated air is captured and returned to the spa's water. This continually helps maintain the water temperature without running the heater as often. The heat recovery system saves you money by reducing electrical cost.

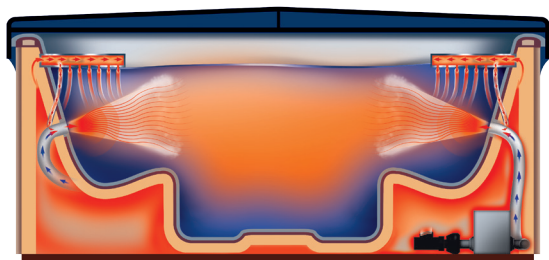

## SOFT-TOUCH™ CONTROLS

State-of-the-art digital electronic control with LCD temperature and filtration readout. All functions are conveniently located at your fingertips.



## MAINTENANCE FREE DURA-FRAME™ CABINET

Select model spas feature our patented, maintenance free Dura-Frame™ cabinets. This powder coated galvanized steel frame cabinet with redwood panels is known for its rich, beautiful appearance and long-lasting durability. Access panel makes service easy.

