

In-ground Solar Reel Instructions

Item # 6575

Locate ALL Components

Before installing your new reel system, please make sure all of the listed parts are in the box.

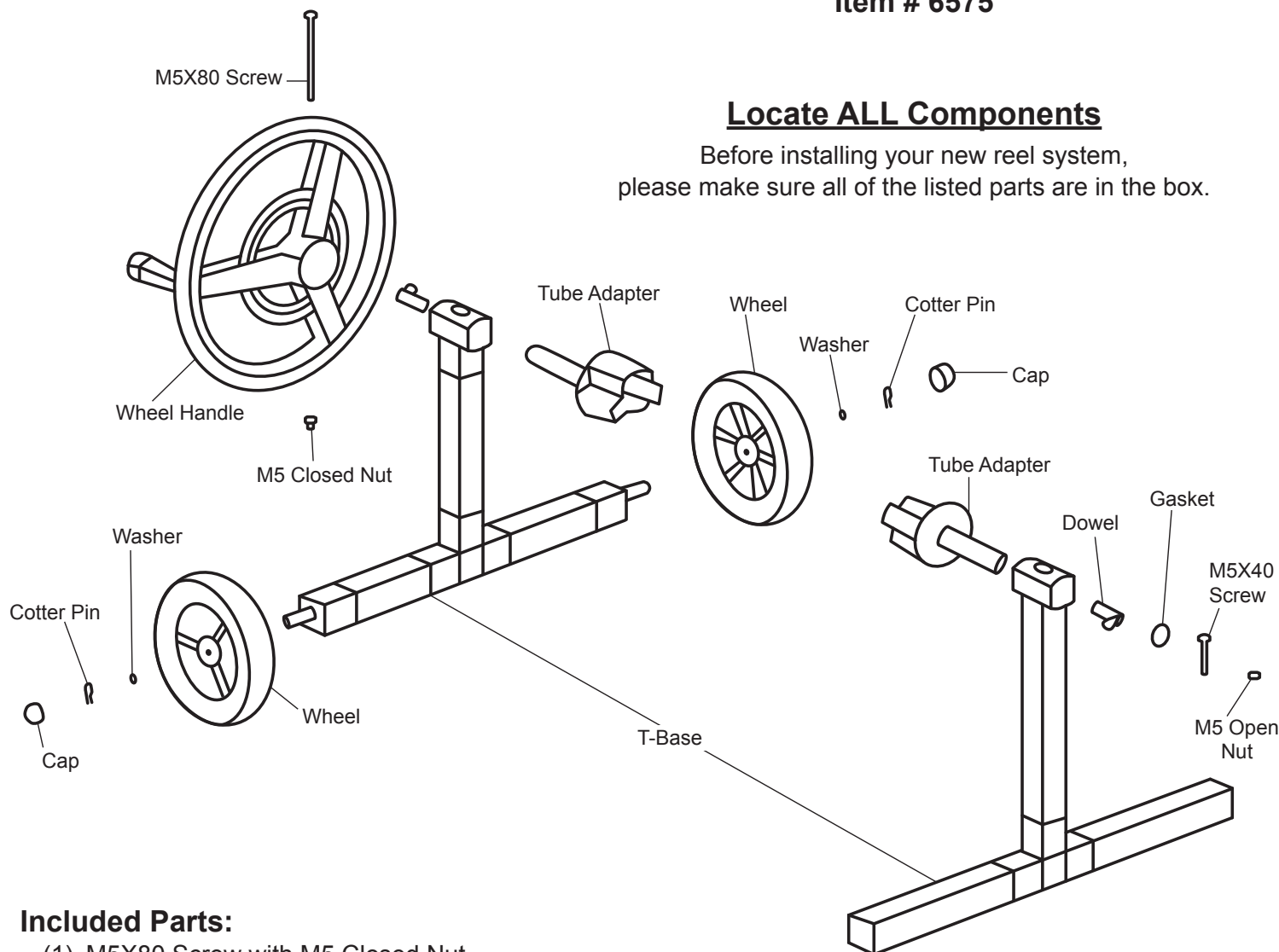

Included Parts:

- (1) M5X80 Screw with M5 Closed Nut
- (1) M5X40 Screw with M5 Open Nut
- (2) Wheels
- (2) T-Bases
- (2) Cotter Pins
- (2) Dowels
- (2) Tube Adapters (1 short, 1 long)
- (3) Washers
- (3) Caps
- (1) Wheel Handle
- (2) Fixations (steel pull brackets)
- (6) 1/2" Screws
- (6) 1-3/4" Screws
- (2) 3/4" Screws
- (14) Elastic Straps
- (3) Tubes (2 small, 1 big - approximately 8'6")

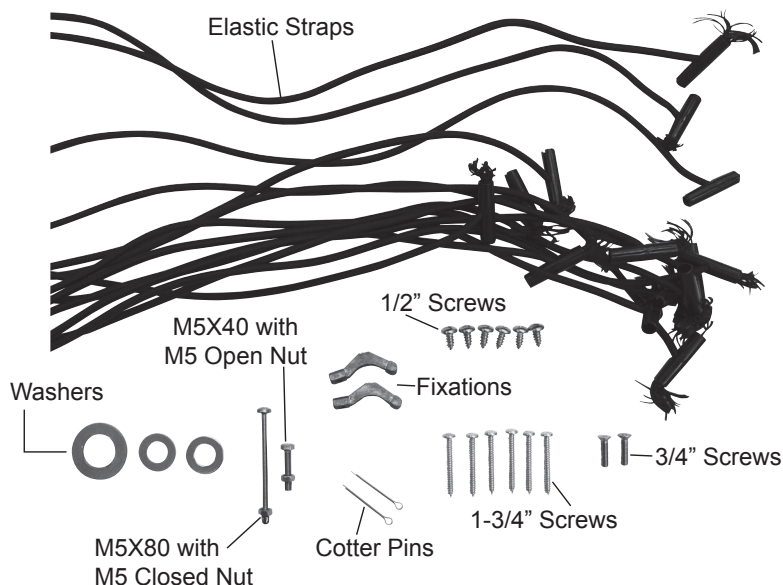

A Installing the Wheels:

1. Reinsert or adjust axle on T-Base. Ensure it is visible from both ends.
2. Slide on the Wheel.
3. Slide on the small Washer.
4. Insert the Cotter Pin through the Axle. Cotter Pin must be bent outward to lock in place.
5. Slide the Cap in place (see Figure 1)
6. Repeat process for second Wheel.



Figure 1

B Installing the Wheel Handle to the Base:

1. Insert the Elastic Straps into the grooves.
 - a. Groove for the straps will not align throughout the Solar Reel (see Figure 2).
 - b. Each Elastic Strap should be evenly placed on the Tubing to provide support for the Cover.
2. Slide the large Tube Adapter into the T-Base.



Figure 2

3. Insert the Dowel into the Tube Adapter

Note: The pedal should be at a 90 degree angle from vertical. This will lock the Tube Adapter in place when turned downwards (see Figure 3).



Figure 3

4. Slide the Wheel Handle onto the top of the Base.
 - a. The Wheel Handle needs to be inserted on the side with the most axle exposed.
 - b. You will need to line up the screw hole in the handle with the pre-drilled hole in the Tube Adapter Axle (you should be able to see through the handle and axle).
 - c. If you are having difficulty with Step 4b, you may need to use a rubber mallet.
5. Insert Screw M5X80 and screw it into the Wheel Handle, followed by the M5 Closed Nut.

C Installing the Tube Adapter to the Base:

1. On the opposite side of the Wheel Handle, insert the Tube Adapter to the top of the Base.
2. Slide the Dowel in place into the Tube Adapter.
3. Place the Washer into the Tube Adapter.
4. Insert Screw M5X40 into the Tube Adapter and screw it into place.
5. Screw M5 Open Nut into the bottom of M5X40 Screw.
6. Slide the Cap into place (may need rubber mallet).

D Installing the Tubes:

1. Insert the Small Tube on to the Tube Adapter. Make sure the (3) screw holes on the tube ends are exposed on each end of the tube that go into the Tube Adapter.
2. Insert the Large Tube, followed by the second Small Tube using the same process in the above Step 1.
3. To secure the Tubes to the Adapter, insert (3) 1-3/4 in. Screws into the Tube Adapter on both ends. Use a drill to tighten (see Figure 4).

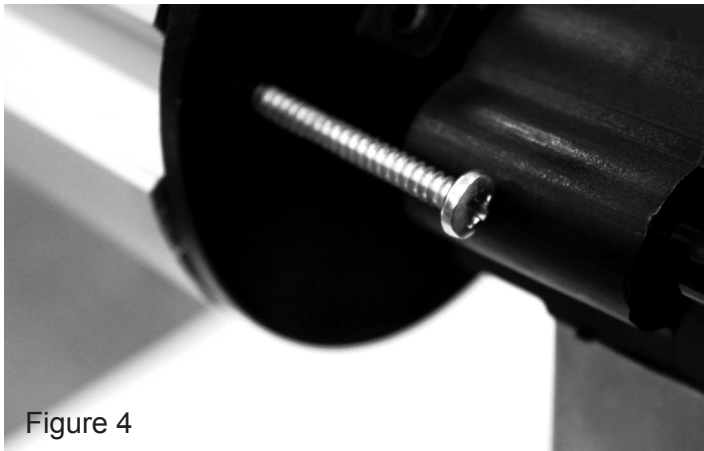

Figure 4

4. Screw (3) 1/2 in. Screws into both Tubes using a drill to tighten (see Figure 5).

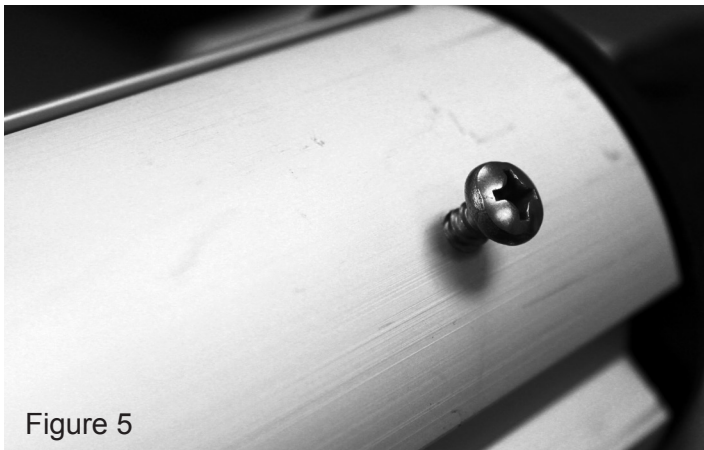

Figure 5

E Attaching the Cover:

1. When positioning the Cover, you should have the Solar Reel near the edge of the pool for rectangular pools. For irregular pools, place the Solar Reel at a midway point near the end of the pool.
2. Using a pair of scissors or screwdriver, carefully punch a hole in the Cover.
3. Fold the Elastic Strap into the casing (see Figure 6) and slide into the Cover.

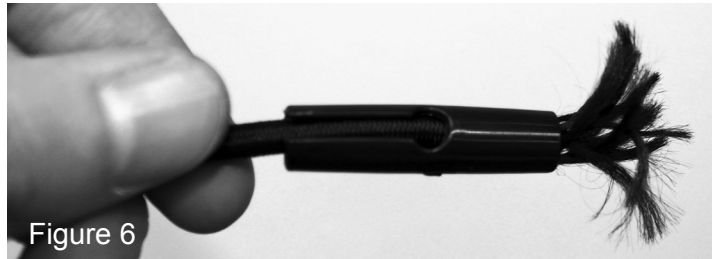

Figure 6

4. Once through the Cover, unfold the Elastic Strap so it is securely locked in place (see Figure 7).



Figure 7

5. If installing the Solar Reel in an offset position, then fold the Cover where the Elastic Straps attach, allowing for the Elastic Straps to go through both sides of the Cover.

F Attaching the Fixation (Steel Bracket):

1. Adjust the length of Tubes to fit the width of your pool.
2. Slide the Fixation (steel bracket) into the groove and slide into place.
Note: When sliding in place, line up the indentation with the screw line.
3. Insert the 3/4 in. Screw into the small groove of the Tubing next to the bracket and drill into place. The Fixation Screw will not drill in, it will compress Tube, locking it into place (see Figure 8).



Figure 8

4. Repeat the steps above to install the second Fixation on the other side of the reel.